



COMO

LENGTH

46.0m (150.9 ft)

BEAM

9.0m (29.5 ft)

DRAFT

2.2m (7.2 ft)

GRT

480 tons

BUILT

2014, Feadship, De Vries, Netherlands

TYPE

Twin screw diesel yacht

CONSTRUCTION

Aluminium hull, aluminium superstructure

ENGINES

2 x 1925hp Caterpillar

SPEED

Cruising 16 knots, Maximum 20 knots

ACCOMMODATION

10 in 5 cabins

CREW

8 in 4 cabins

EXTERIOR DESIGNER

Dubois Naval Architects

INTERIOR DESIGNER

Redman Whiteley Dixon

LYING

Europe

All particulars are believed to be correct but cannot be guaranteed.

Yacht Specification

BURGESS

tel:+44 20 7766 4300

london@burgessyachts.com

www.burgessyachts.com













































































TIT COMO















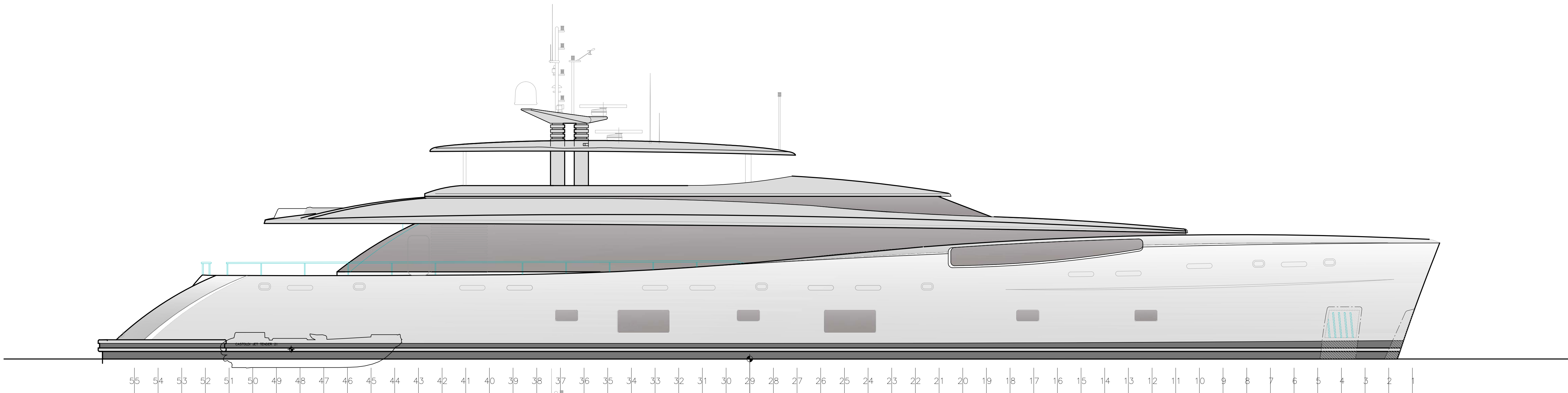

OUTBOARD PROFILE

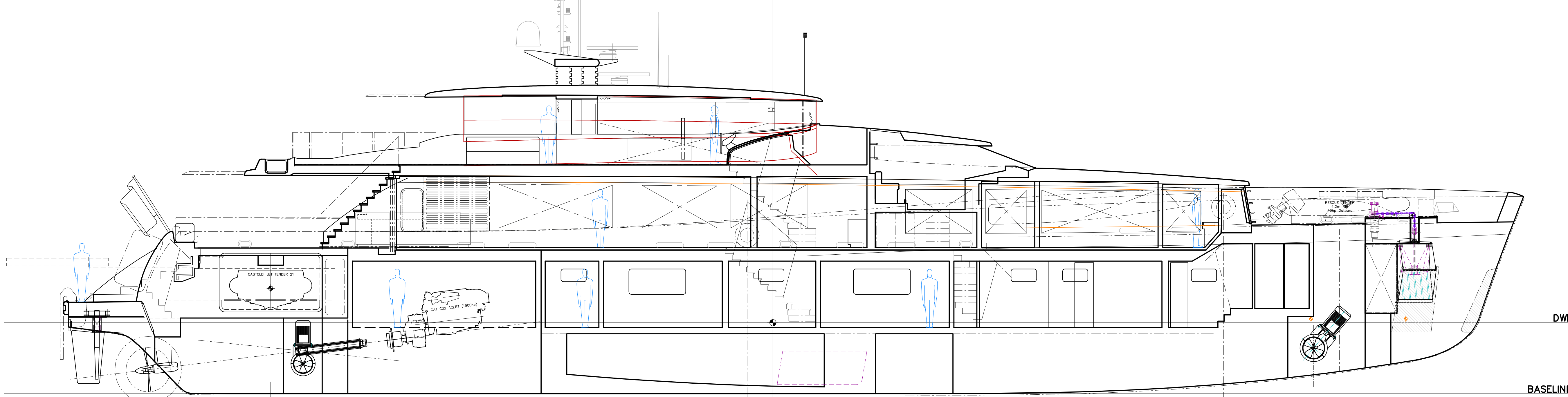

SECTION

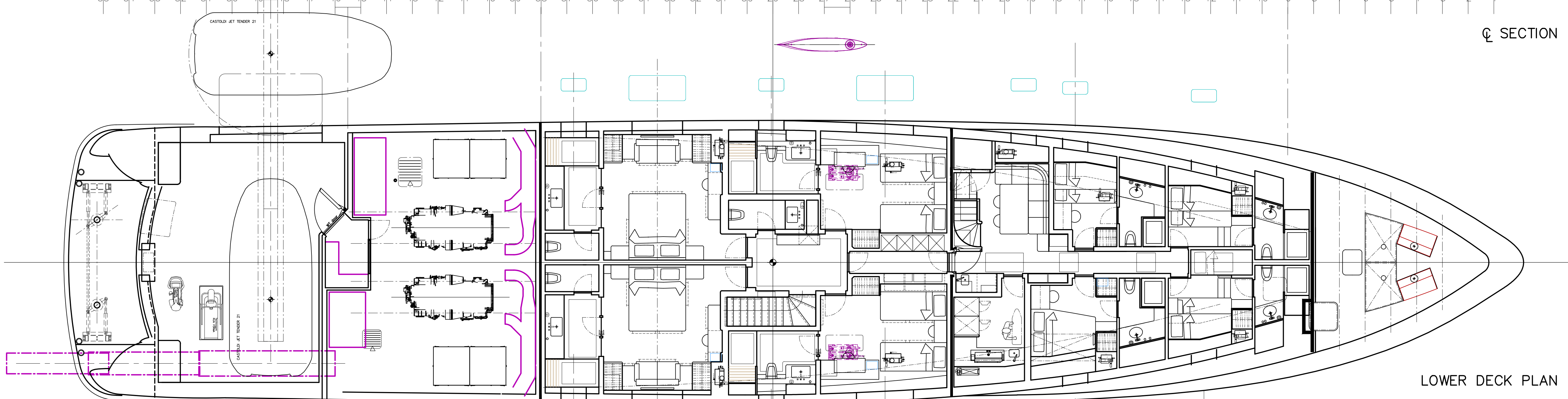

LOWER DECK PLAN

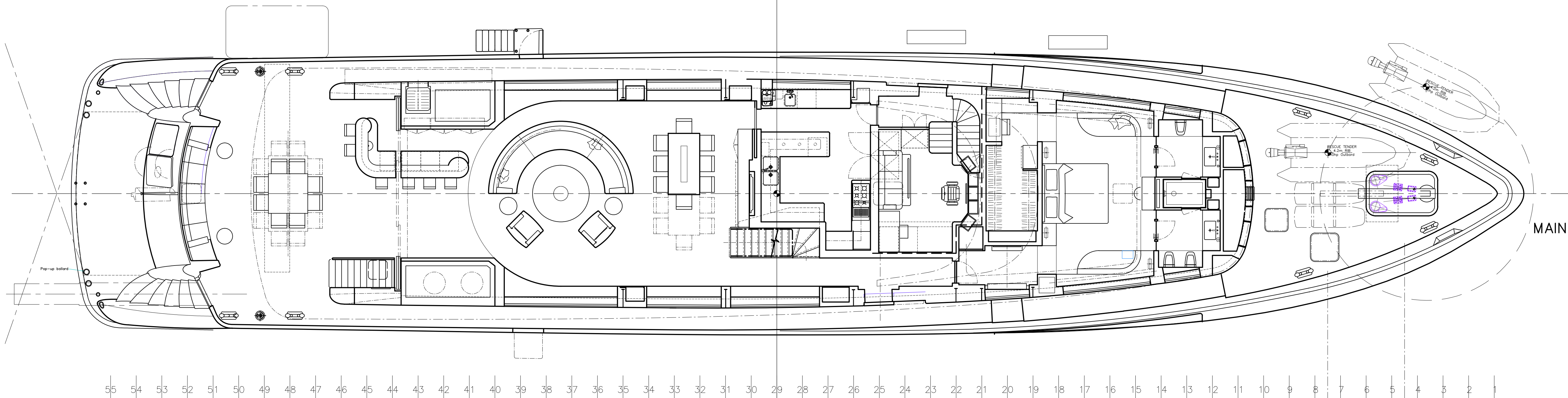

MAIN DECK PLAN

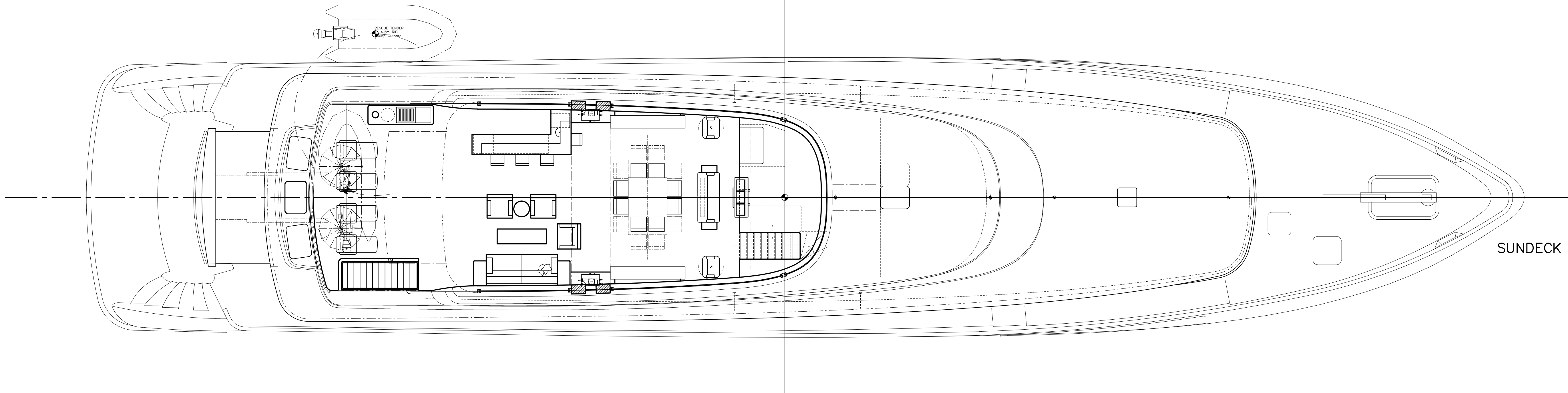

SUNDECK PLAN

46m Motor Yacht

PRINCIPAL DIMENSIONS

LOA	46.200 m
LENGTH ON DESIGN WATERLINE	44.580 m
LPP	44.580 m
BEAM MAX	9.000 m
CANOE BODY DRAFT at DWL	2.250 m
DWL DRAFT TO USK	2.250 m
DWL DRAFT TO BASELINE	2.250 m
DWL DISPLACEMENT	352 t

DUBOIS NAVAL ARCHITECTURE & YACHT DESIGN

DUBOIS NAVAL ARCHITECTS LTD. Back Farm, Sawley, Lymington, Hampshire, SO41 5SR, UK.
Tel: +44 (0)1590 626666 Fax: +44 (0)1590 626666 Email: design@duboisyachts.com Web: www.duboisyachts.com

Title	General Arrangement	Design no.	368
Vessel	46m Motor Yacht	Sheet no.	1 of 1
Scale	1:75 @ A0	File	368a_ga
		Date	17/12/08

WORLD COPYRIGHT © - COPYING, REPRODUCTION OR STORAGE OF ALL OR ANY PART OF THIS DESIGN, WHETHER BY DRAWING, OPTICAL, ELECTRONIC OR IN THREE-DIMENSIONAL FORM IS PROHIBITED WITHOUT THE EXPRESS PERMISSION OF DUBOIS NAVAL ARCHITECTS LTD., UK.